

PARTIAL SITE PLAN @ SCALE 1" = 20'

NOTE: ALL TREES INDICATED ARE EXISTING AND ARE TO REMAIN EXCEPT MADRONA NOTE ON PLAN TO "REMOVE"

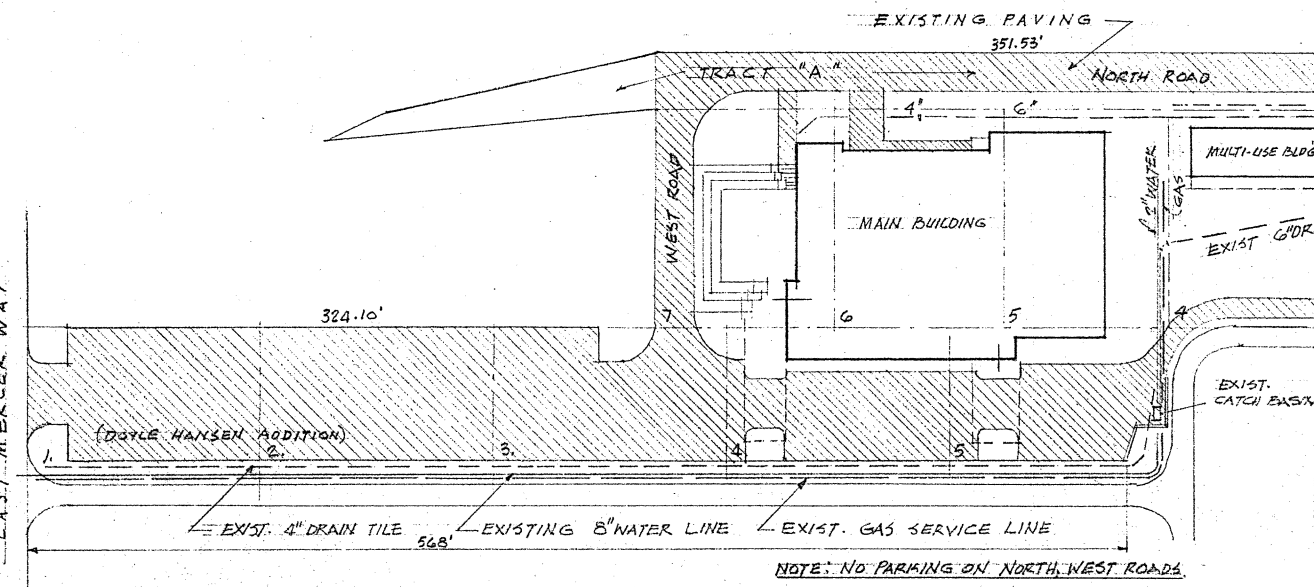
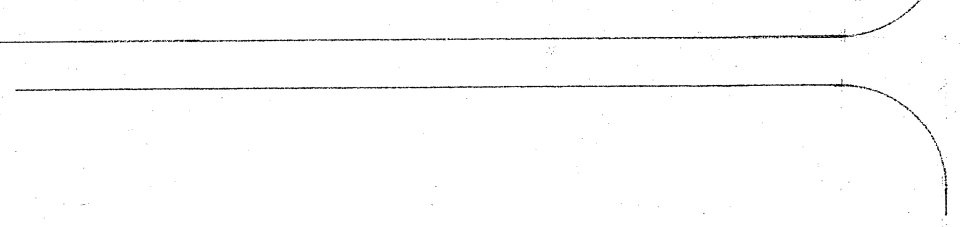
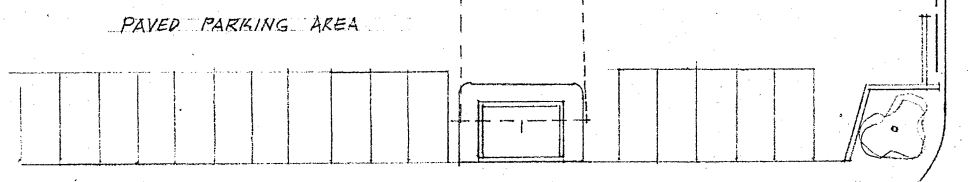

SITE, PLAT, UTILITIES, PLAN @ SCALE 1" = 50'

12/21/79  
UTILITIES DEPT.  
A PERMIT IS REQUIRED TO CONNECT TO THE EXISTING SIDE SEWER. A LICENCED SIDE SEWER CONTRACTOR IS REQUIRED TO MAKE THE CONNECTION. FOR ASSISTANCE IN LOCATING THE SIDE SEWER CALL SWEN OLSON AT 232-8135.  
THE NEAREST POINT FOR DOMESTIC WATER SERVICE IS AT THE FIRE HYDRAN NEAR THE MAIN BUILDING.  
APPLICATION FOR WATER SERVICE IS MADE AT THE UTILITIES DEPT.  
RESIDENCE ON ABUTTING PROPERTY.  
A STREET USE PERMIT IS REQUIRED.

LEGAL: LOTS 1 THRU 9 DOYLE-HANSEN ADDITION REC. IN VOL. 75 OF PLATS, PAGE 24, & LOTS 1 THRU 7, CHANNEL CREST RECORDED IN VOL. 72 OF PLATS, PAGE 63, TOGETHER WITH THAT PORTION OF TRACT A, CHANNEL CREST, VOL. 72, PAGE 63, ALL IN KING COUNTY.

HERZL-NER TAMID CONSERVATIVE CONGREGATION  
3700 East Mercer Way  
1979 Playfield & Custodian's House

PLANS APPROVED  
DATE 12/20/79  
BY [Signature]  
BUILDING OFFICIAL  
CITY OF MERCER ISLAND

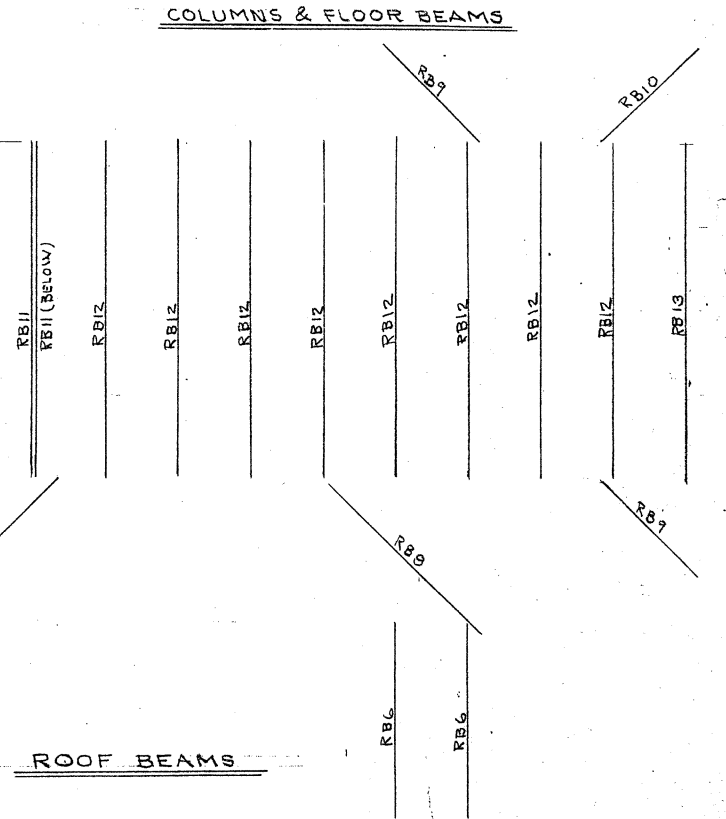
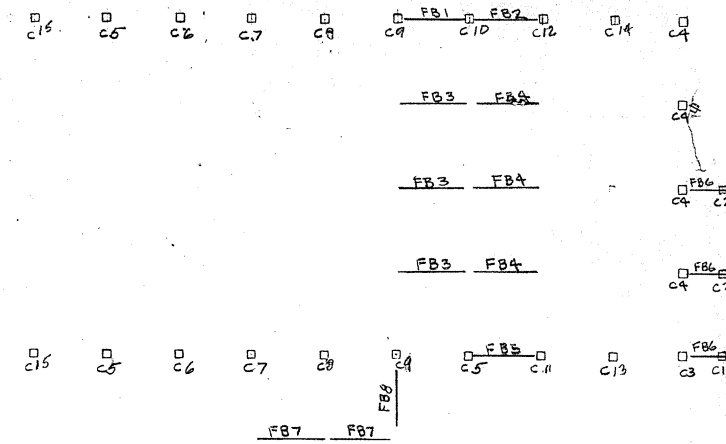
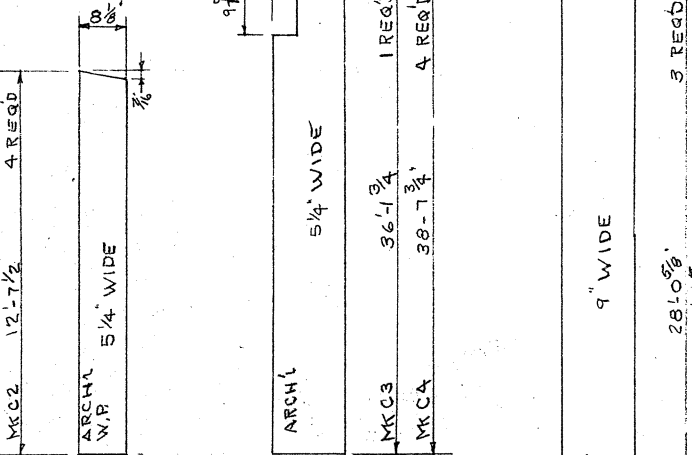
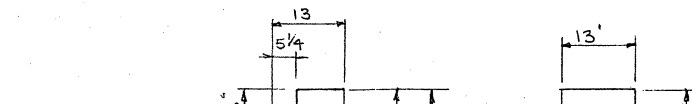
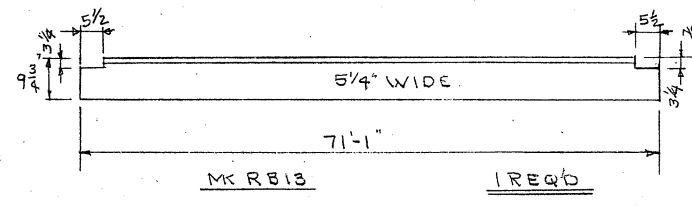
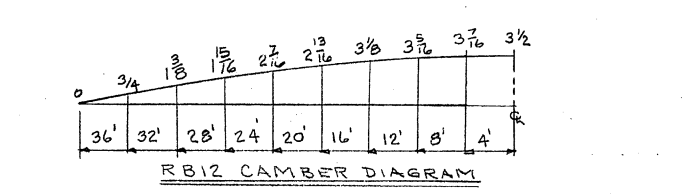
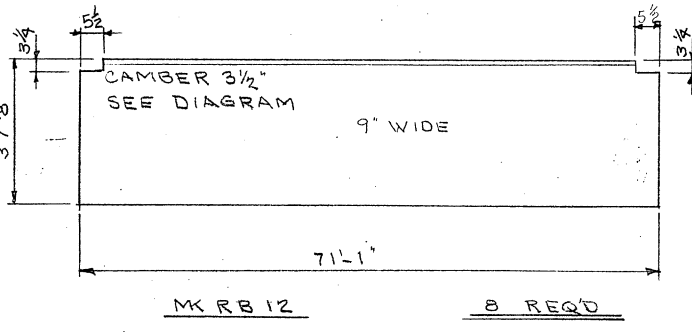
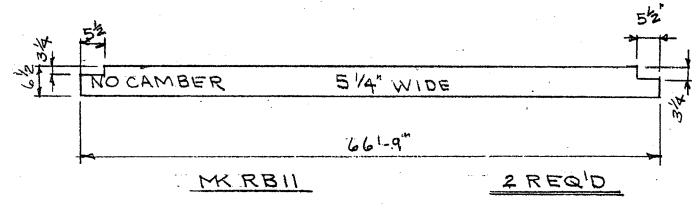
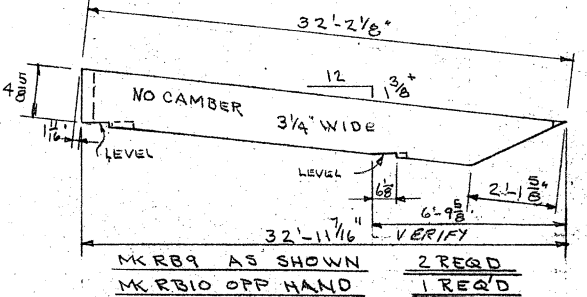
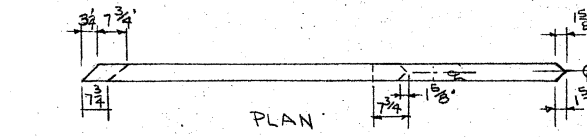
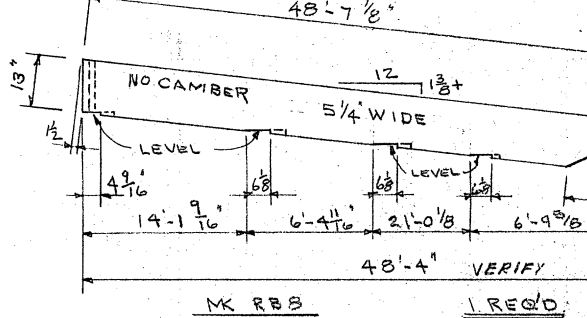
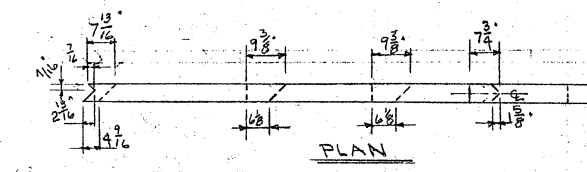
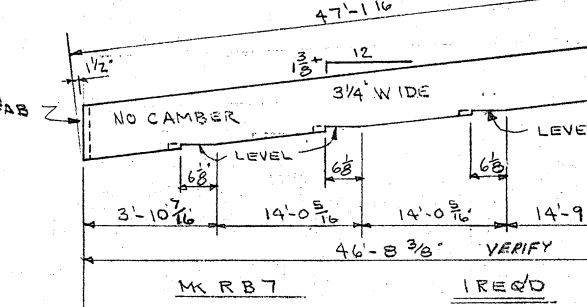
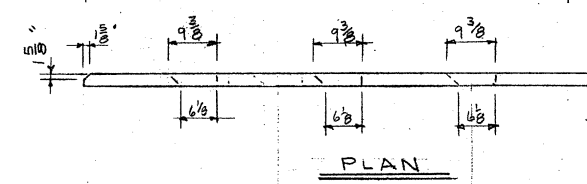
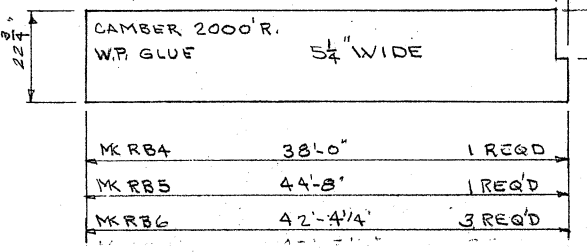
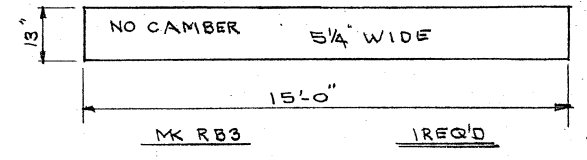
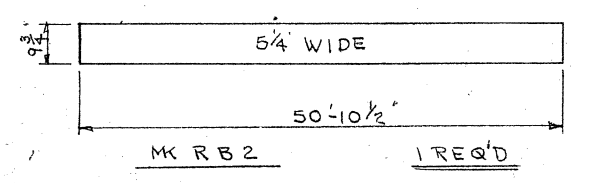
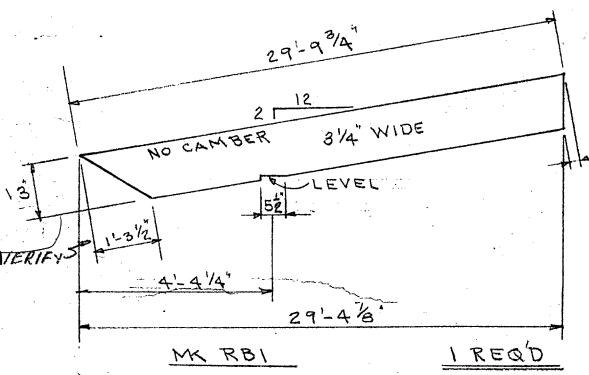
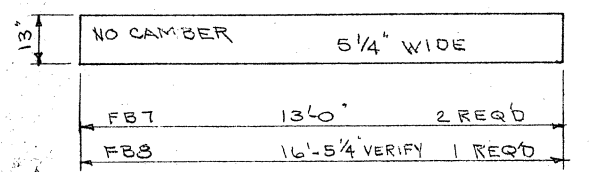
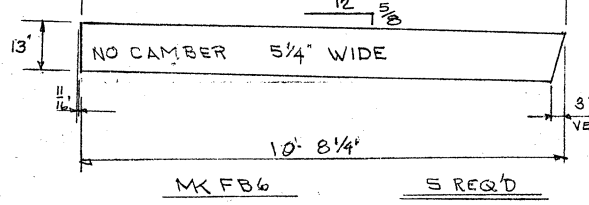
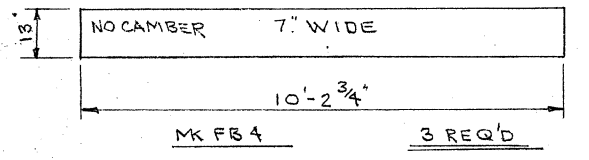
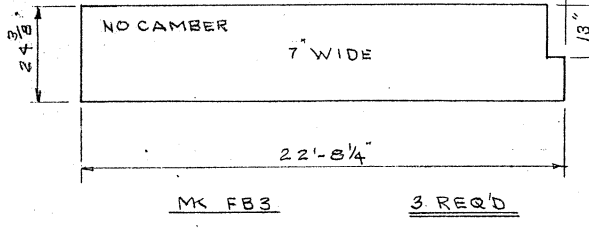
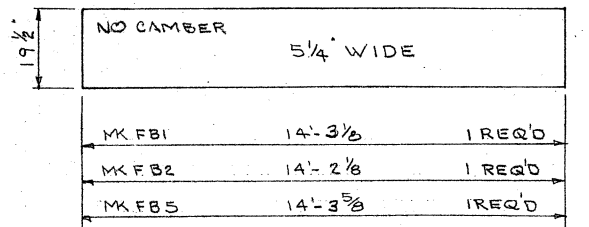

**SPECIFICATIONS**  
 F=2200  
 CASEIN GLUE EXCEPT AS NOTED  
 INDUSTRIAL APPEARANCE  
 EXCEPT AS NOTED  
 COLS, 2 COATS PENETRATING  
 SEALER, OTHERS END SEAL  
 ONLY,  
 LOAD WRAP  
 AITC CERTIFICATE

RECEIVED  
 JAN 21

SANCTUARY & SOCIAL CENTER  
 HERZL-NER-TAMID CONSERVATIVE CONGREGATION  
 MERCER ISLAND, WASHINGTON  
 JAMES J. CHIARELLI - AIA

RIDDLE LAMINATORS  
 P.O. BOX 66  
 RIDDLE OREGON

Job No 71002  
 DATE 1-12-71  
 SH No 1.091  
 DICK W. EBELING  
 CONSULTING STRUCTURAL ENGINEER  
 715 DEKUM BUILDING  
 PORTLAND, OREGON 97208